



# ST10 STEEL RAILING SYSTEM



## CLASSIC STYLE. UNWAVERING PERFORMANCE.

**Sturdy steel railing designed with superior strength and lasting durability.**

With a focus on quality and longevity, the RailMaster ST10 Steel Railing System offers a reliable and stylish solution for any project, ensuring both aesthetic appeal and structural integrity in every installation. The pre-assembled panels and posts with pre-mounted brackets are designed for quick installations, helping you save time and money. The premium powder coating technology provides superior anti-corrosion and weather resistant performance.

- Pre-Galvanized Heavy Gauge Steel
- Zinc-Rich Black Powder Coated Matte Finish
- 15-year Limited Warranty for Residential Applications
- 10-year Limited Warranty for Commercial Applications

### *4-Layer-Protection Powder Coating Technology*

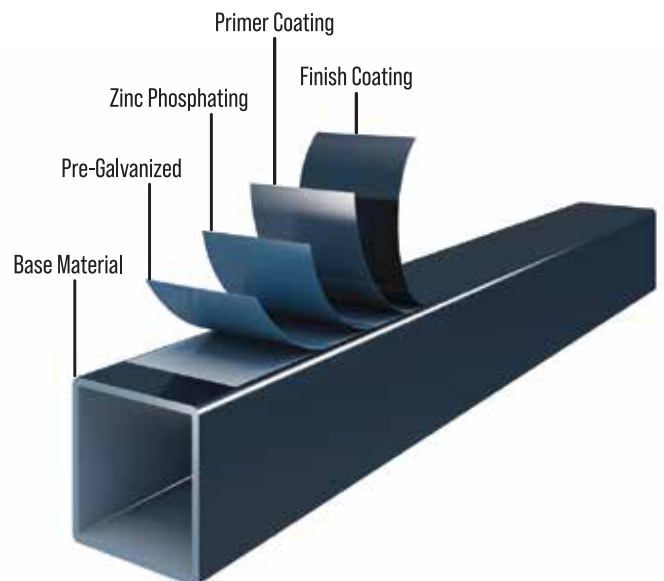

# ST10 LEVEL RAIL PANEL

- Factory Assembled Panel for Ease of Installation
- Square Balusters: 5/8" x 18 ga
- Top and Bottom Rails: 1-1/4" x 14 ga

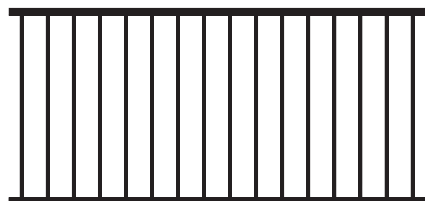

6' Wide Level Rail Panel

LEVEL RAIL PANEL		
N24919	6'x34" (for finished rail height of 38")	16 Square Balusters
N24921	8'x34" (for finished rail height of 38")	21 Square Balusters
N24924	10'x34" (for finished rail height of 38")	26 Square Balusters
N24934	6'x40" (for finished rail height of 42")	16 Square Balusters
N24938	8'x40" (for finished rail height of 42")	21 Square Balusters

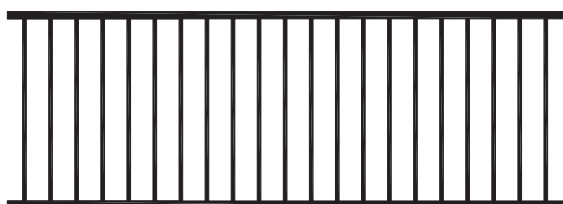

8' Wide Level Rail Panel

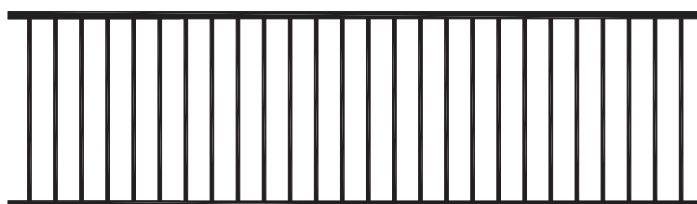

10' Wide Level Rail Panel

# ST10 STAIR RAIL PANEL

- Factory Assembled Panel for Ease of Installation
- Square Balusters: 5/8" x 18 ga
- Top and Bottom Rails: 1-1/4" x 14 ga
- Stair brackets with pivoting design and hinged baluster panels are versatile for adapting to different stair layouts

STAIR RAIL PANEL		
N24927	6'x34" (for finished rail height of 38")	16 Square Balusters
N24930	8'x34" (for finished rail height of 38")	21 Square Balusters
N24941	8'x40" (for finished rail height of 42")	21 Square Balusters

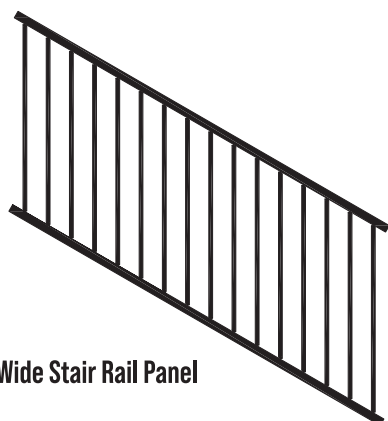

6' Wide Stair Rail Panel

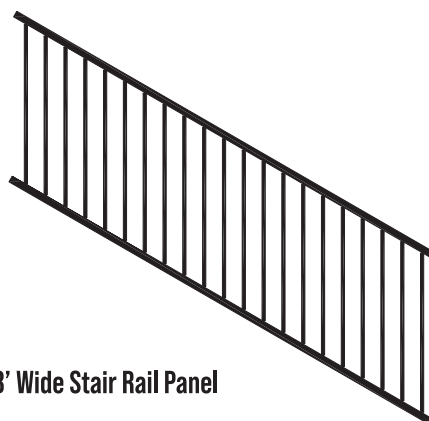

8' Wide Stair Rail Panel

# ST10 POST KITS

- Posts Available in 2"x2"x14 ga [3.8" sq base plate] and 3"x3"x14 ga [5.25" sq base plate]
- 40"H Post with Pre-mounted Brackets for 34" Panel with 4" Bottom Space
- 44"H Post with Pre-mounted Brackets for 40" Panel with 2" Bottom Space
- 40"H, 44"H, 46"H and 48"H Blank Posts

2" x 2" x 40"	
N24918	End Post
N24920	Corner Post
N24976	Mid Post

2" x 2" x 44"	
N24974	End Post
N24975	Corner Post
N24972	Mid Post

FASCIA POST	
N25287	2" x 2" x 52"

2" x 2" BLANK POST	
N24923	2" x 2" x 40"
N24926	2" x 2" x 44"
N25030	2" x 2" x 46"
N25031	2" x 2" x 48"

3" x 3" x 40"	
N24940	End Post
N24943	Corner Post
N24937	Mid Post

3" x 3" x 44"	
N24932	End Post
N24935	Corner Post
N24929	Mid Post

3" x 3" BLANK POST	
N24946	3" x 3" x 40"
N24949	3" x 3" x 44"
N25032	3" x 3" x 46"
N25033	3" x 3" x 48"

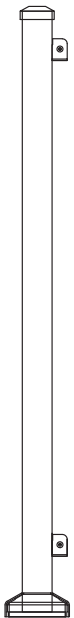

End Post

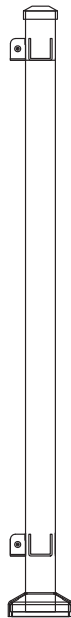

Corner Post

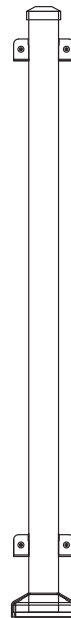

Mid Post



Blank Post



Fascia Post

**End, Corner & Mid Post Kits** include Pre-mounted Brackets for Faster Installation, Post Cap, Post Skirt, Rail/Bracket Covers, and Screws (for securing brackets to the panel)

**Blank Post Kit** includes Post, Post Cap, and Post Skirt

**Fascia Post Kit** includes Post and Post Cap

# ST10 GATES

## FACTORY ASSEMBLED GATES

- Factory Assembled Gate for Ease of Installation
- 7 Square Balusters: 5/8" x 18 ga
- Top & Bottom Rails: 1-1/4" x 14 ga

## GATE UPRIGHT KITS

- Includes 2 uprights and screws to fasten to panel (sold separately)

## SWING GATE KIT

- Use to complete assembly of gates

FACTORY ASSEMBLED GATES	
N24978	34.5"x34" Assembled Gate for 36" Finished Opening
N24979	34.5"x40" Assembled Gate for 36" Finished Opening

GATE UPRIGHT KITS	
N24980	34" Gate Uprights for Custom Width Gates (2 pc)
N24981	40" Gate Uprights for Custom Width Gates (2 pc)

SWING GATE KIT	
N24982	Swing Gate Kit (Includes 1 Latch & 2 Hinges)



Assembled Gate

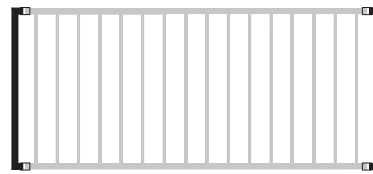

Gate Uprights

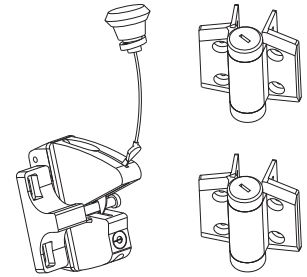

Swing Gate Kit

# ST10 ACCESSORIES & PARTS

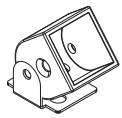

Angle Bracket

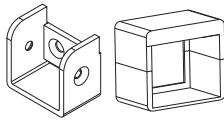

Bracket with Rail / Bracket Cover

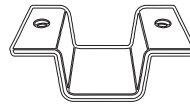

Drink Rail Bracket

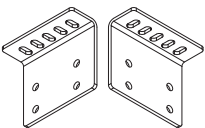

Bracket Kit for Fascia Post

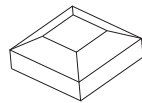

Post Cap

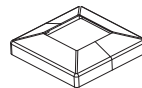

Post Skirt



Touch Up Spray



Touch Up Pen

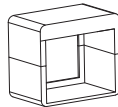

Rail / Bracket Cover



Torx Head Screw

ACCESSORIES	
N24942	Angle Bracket for Stair or Level Rail*
N25482	Bracket with Rail / Bracket Cover*
N26342	Drink Rail Brackets, 4 pack*
N25290	Bracket Kit for 2" Fascia Post (2 L-plates)
N26172	Bracket Kit for 3" Fascia Post (2 L-plates)
N24953	2" Post Cap
N24958	2" Post Skirt
N24964	3" Post Cap
N24970	3" Post Skirt
N26409	Black Touch Up Paint - Aerosol Can, 12.5 oz
N26410	Black Touch Up Paint - Pen, 3 oz

\*Includes Screws

REPLACEMENT PARTS	
N25478	Rail / Bracket Cover
N24977	M4.8x16mm-Torx Head Screw, 12 pk



MasterHalco.com

Branch service centers are located throughout North America. RailMaster is a registered trademark of Master Halco. ©8/24

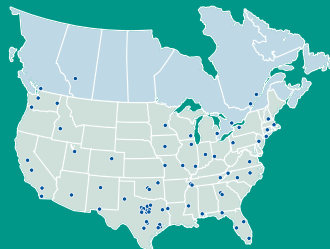

Scan me!

Find your local Master Halco branch and contact us today!